

PT. 01:

1. FINISH TO ORDER
2. INSPECT
3. ASSEMBLE

PT. 02:

1. FINISH TO ORDER
2. INSPECT
3. ASSEMBLE

ASSEMBLY:

1. ASSEMBLE
2. ASSEMBLE
3. FINAL INSP.

4. SHIPPING

BIENT ZZIXW

Form C-13-06

.616 WAS .7160
 .508 WAS .5160
 .258 WAS .330
 .355 WAS .500
 WORKING
 POSITION ADDED
 LBS/M WAS
 30.3 21
 K.D. 21
 3-26 85
 O.P.S. ADDED
 REF. NAME
 O.P. NO. WAS
 2009185JWS
 K.D. 21
 3-18-85
 3
 DWG NO. WAS
 0097-C-0951
 .0162 WAS
 .018
 MAT'L THICKNESS
 WAS .0042
 P.T. 02 ADDED
 K.D. 21
 4
 10-21-85
 ADDED
 4-500
 REMOVED DETAIL
 P.T. 02 WAS REC'D.
 P.T. 01 WAS I/L
 WAS 7.00
 K.D. 21
 12-10-85
 5
 P.T. 03 WAS
 8041-D-095A
 K.D. 21
 8-7-86
 6
 14.970 WAS 15.000
 .548 WAS .700 4
 REVISED VIEW
 4 ANVIL
 9-5-86
 7
 1.500 WAS
 4.500
 *NOTE REVISED
 P.T. 03 WAS
 4 LEGID
 K.D. 21
 11-26-86
 8
 97-944 WAS
 97-950-
 CHANGE SHAPE
 OF RIVET
 ECN4118
 805-24-87
 9
 ADD OPTO
 ASSEMBLE
 ECN5123
 805-24-87
 10
 ES 3-27-91

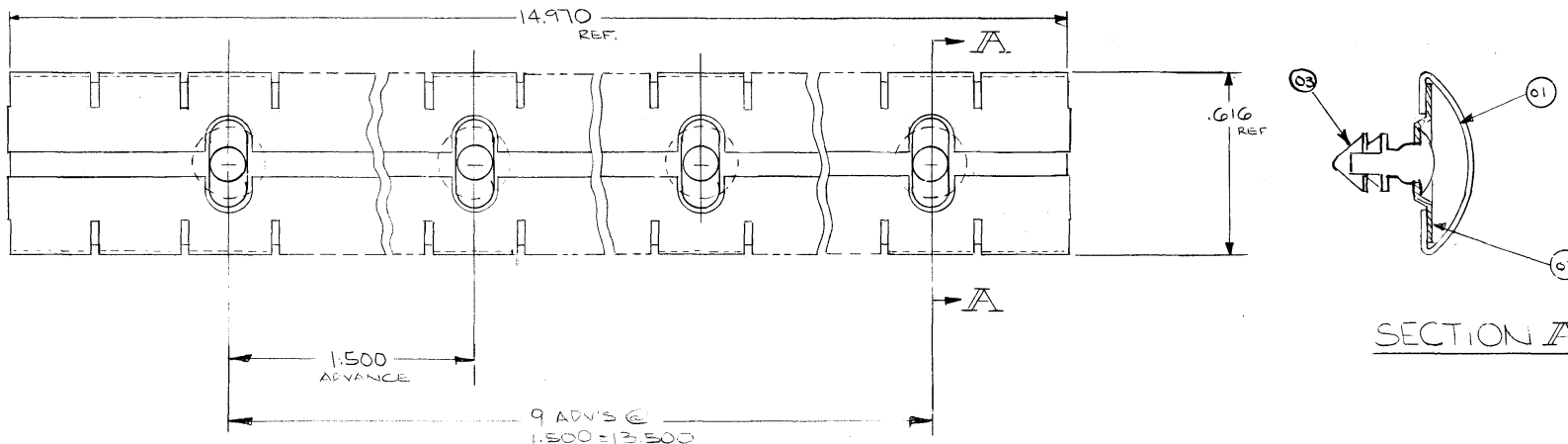
 DWG. 0097-C-0952
 NO.

REQ'D	ITEM	MATERIAL
10	03	FASTENER - SEE DWG 0097-D-0944 ①
1	02	.0162 X .600 BRASS REF. SEE DWG. 0097-C-0932
1	01	.0038, X 1.320 BE.CU. REF. SEE DWG. 0097-C-0931
INSTRUMENT SPECIALTIES COMPANY, Inc. DELAWARE WATER GAP, PA		
DRAWN BY CRS		DATE 3-21-85
APPROVED <i>[Signature]</i>		DATE 3/21/85
SCALE 2:1		SUB 10
REF. DWG.		DWG. NO. 0097-C-0952

 TOL UNLESS
 OTHERWISE SPEC.
 DEC ± .010
 FRACT. ±
 ANGLES ±

0097-C-0952